

# 1

## Attach The Pattern

Properly position the pattern on the surface, making sure the baseline of the pattern is level. Attach the pattern to the surface by securely taping the corners and sides to prevent movement. Be certain the pattern is flat against the surface, wrinkles can cause holes to become misaligned.

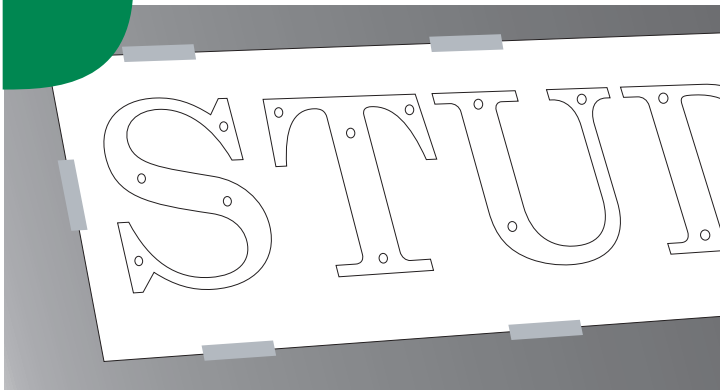

# 2

## Drill Holes

Drill 1/4" diameter holes where indicated on template and into wall. Remove template from wall and clean out each drilled hole thoroughly using compressed air or soft brush.

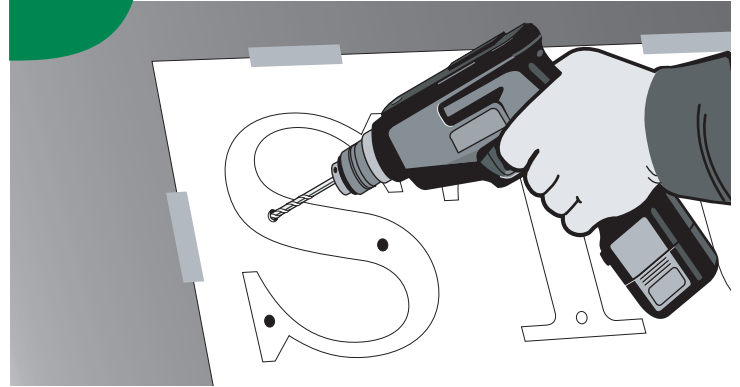

# 3

## Insert Studs

Insert threaded studs (supplied) into the back of each letter or element. Depending on the material, the back of the product will either have predrilled, threaded holes or acrylic pads with spacers for inserting the studs. Spacers are also available for products with predrilled holes.

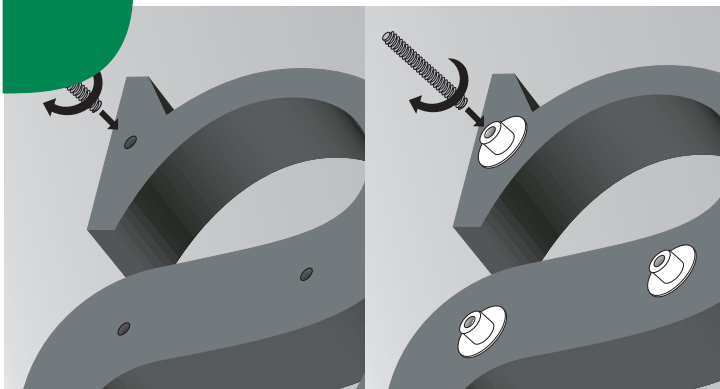

# 4

## Mount To Surface

Fill the holes for the first letter or element with silicone. Spread silicone liberally on each stud of the first letter or element and push into drilled holes. Use masking tape to hold in place until cured. Repeat for each letter or element. Allow 5-6 hours for silicone to cure, then remove masking tape.



**chesapeake**  
**SIGN**  
**company**<sup>INC</sup>

10540 York Road  
Suite E  
410-66-SIGNS (74467)  
Fax: 410-667-4469  
[www.chesapeakesign.com](http://www.chesapeakesign.com)  
[info@chesapeakesign.com](mailto:info@chesapeakesign.com)